

KITCHEN CABINET DESIGN - FLAT 1

JVL - Interiors

Height of room - 2350mm

Used area - 5448mm

Width of room - 5580mm

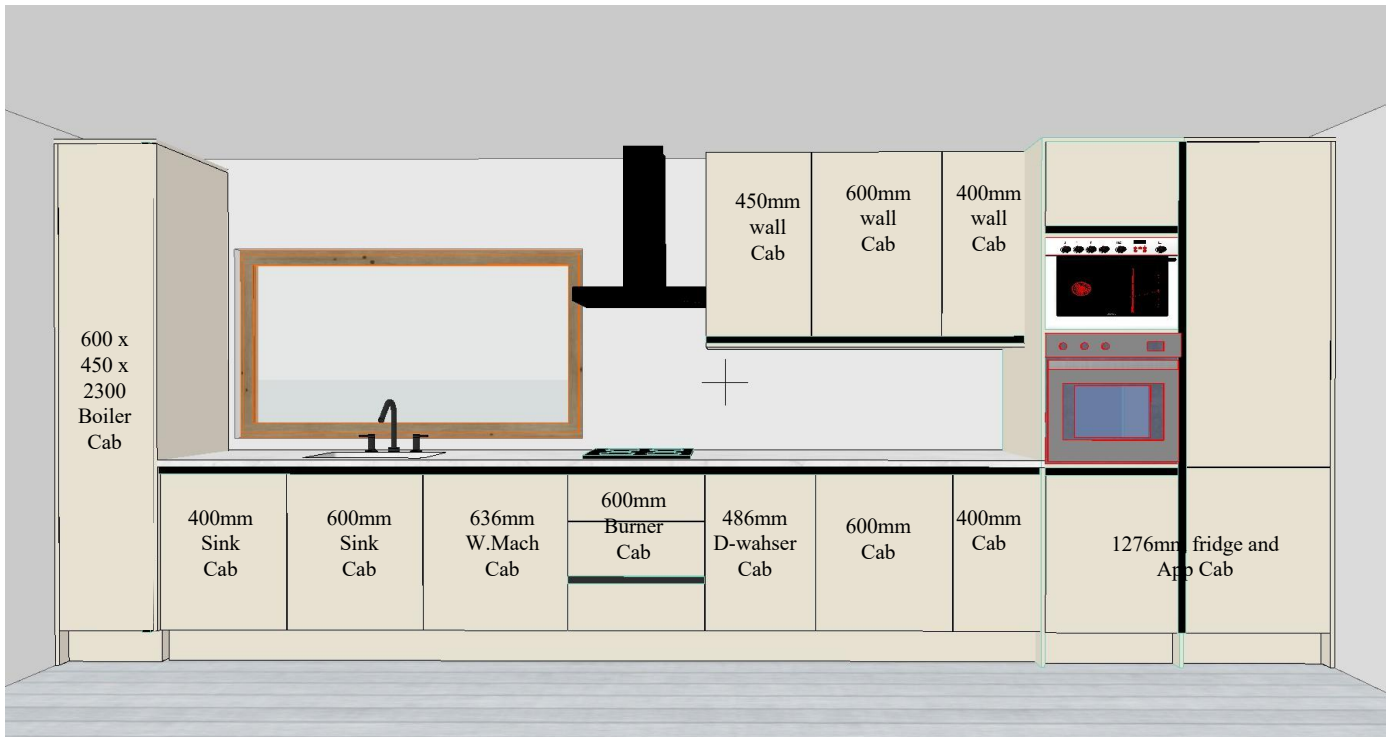
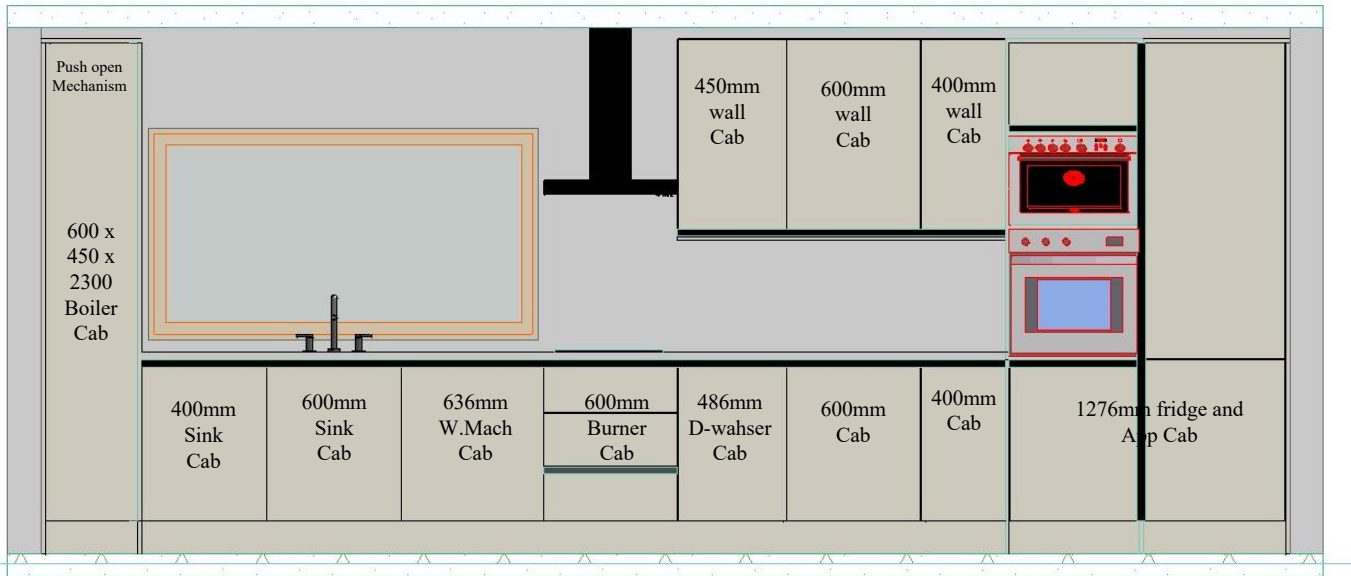

Depth of wall cab - 350mm
Height of Wall cab - 900mm

Depth of Base Cab - 600mm
Height of Base cab - 900mm

KITCHEN CABINET DESIGN - FLAT 2

JVL - Interiors

Height of room - 2400mm

Depth of wall cab - 350mm
Height of wall cab - 900mm

Depth of Base cab - 600mm
Height of Base cab - 900mm



882 wall cabinet (corner) with 300 door

882 wall cabinet (corner) with 300 door

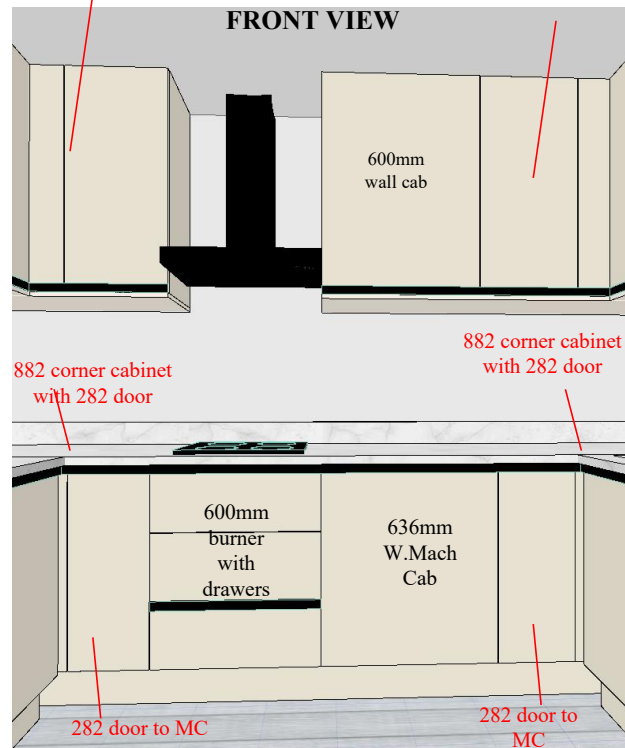

LEFTVIEW

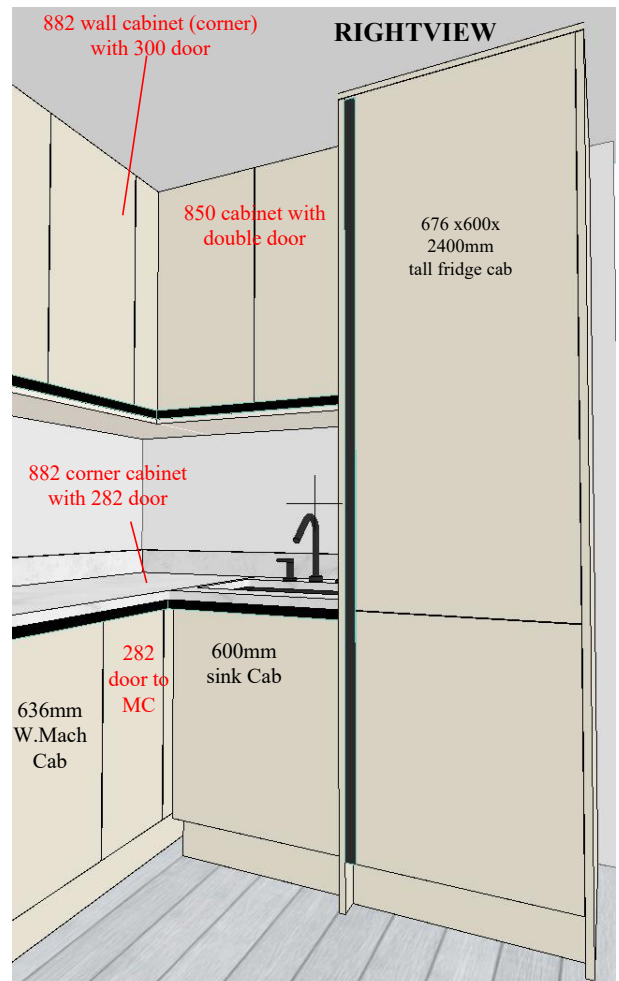
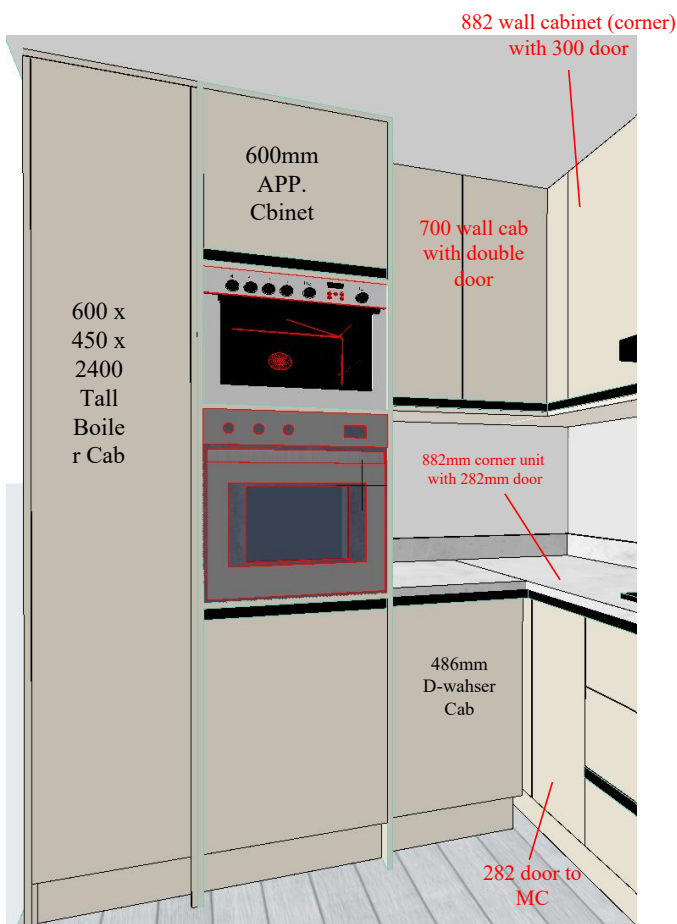

KITCHEN CABINET DESIGN - FLAT 3

JVL - Interiors

Height of room - 2320mm

Width of room - shorter side -16800mm

Width of room - longer side -4100mm

Used area - 4022mm

Used area - 1576mm

600x300mm top cab

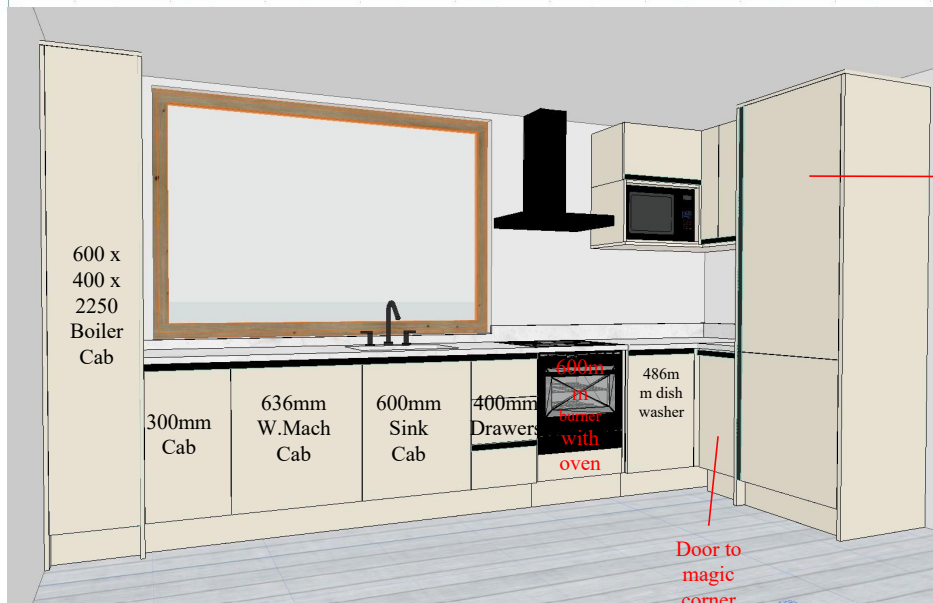
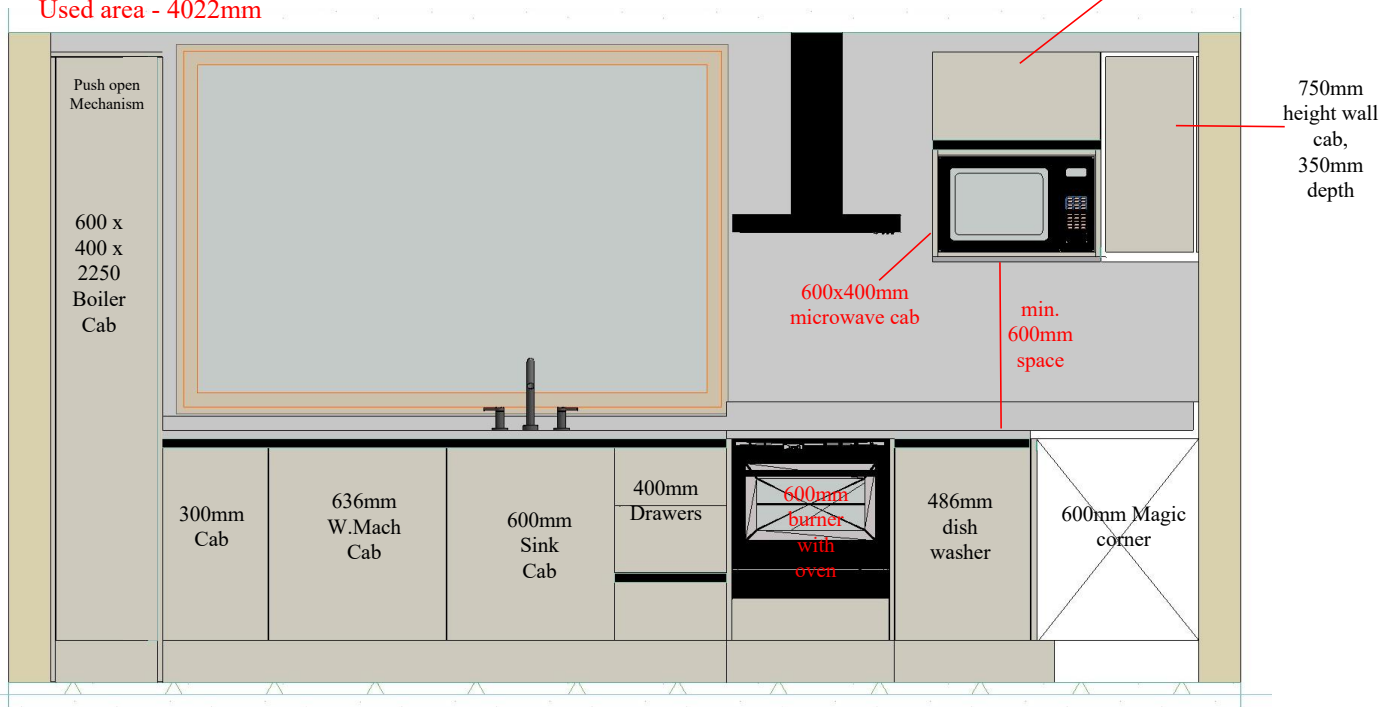

Depth of wall cab - 350mm
Height of wall cab - 750mm

Depth of Base cab - 600mm
Height of Base cab - 900mm

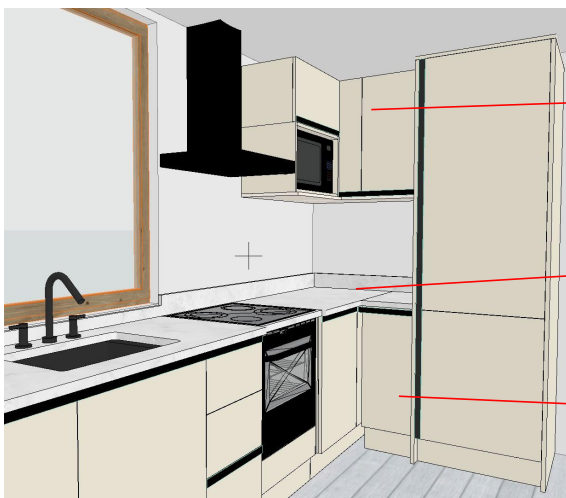

Prepared and Designed by JVL - Interiors

KITCHEN CABINET DESIGN - FLAT 4

JVL - Interiors

Height of room - 2500mm

Width of room - longer side - 3700mm

Used area - 3636mm

Width of room - shorter side - 2570mm

Used area - 2512mm

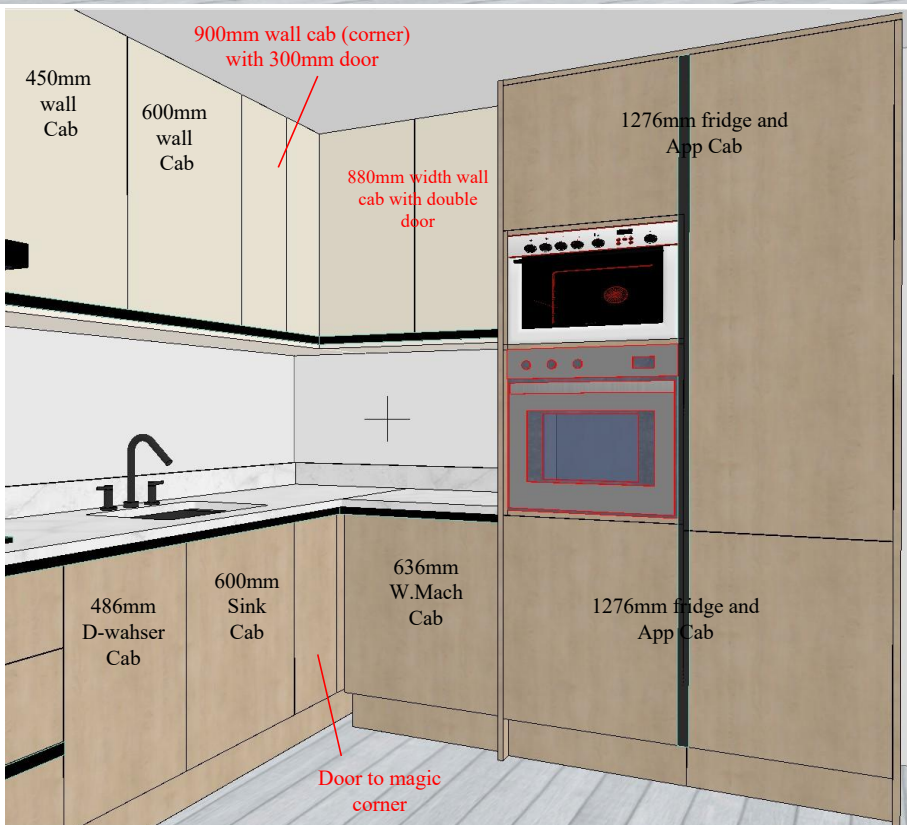
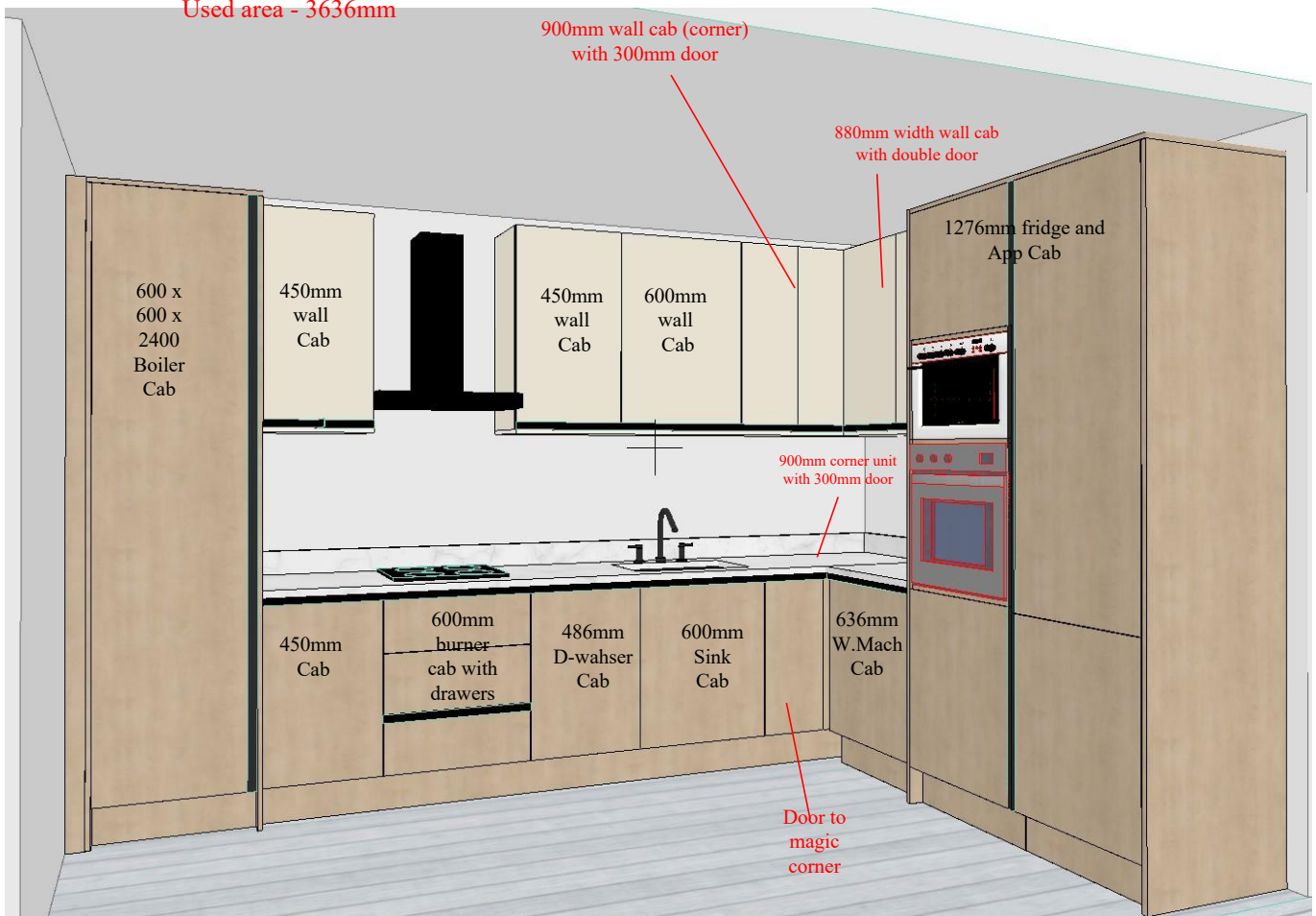

Depth of wall cab - 350mm
Height of wall cab - 900mm

Depth of Base Cab - 600mm
Height of Base cab - 900mm

Prepared and Designed by JVL - Interiors